



# THINK. MODEL. LEARN.™ MATH CENTERS: GRAPHING DATA ACTIVITY GUIDE

## PRODUCT INCLUDES:



Activity Guide

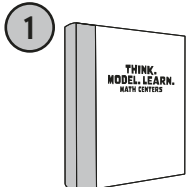

Storage Box

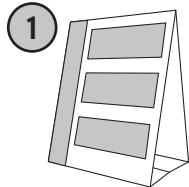

Instruction Tent

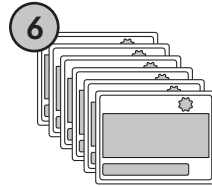

Student Activity Mats

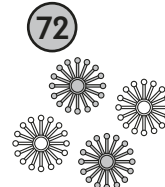

Gears

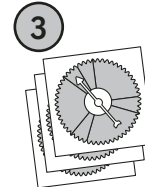

Spinners

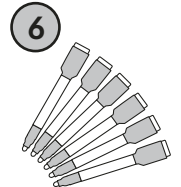

Dry Erase Markers



### PURPOSE:

Empower children to independently practice graphing data! This center is standards aligned for grades K-1 and geared for skill differentiation – it is double-sided for practice on two skill levels: sorting and counting and interpreting data. Students also build number sense and addition skills as they model and tally amounts. This hands-on, engaging center is sure to make skill-building fun as students think, model, and learn!



### SET UP:

Each activity mat will accommodate one student. Six activity mats are provided for up to six students total. Three packs of gears are provided, each pack to share between a pair of students.

1. Provide each pair of students with a 24 pack of gears.
2. Provide each pair of students with a spinner and two dry erase markers.

We recommend explaining instructions to students before independent play. Place the tent where students can see it for instruction reminders and visuals during use.



### HOW TO USE:

**Step 1:** Spread the gears out in front of you and your partner. Decide who will go first.

**Step 2:** On your turn, spin the spinner and collect or return the matching colored gears. Place your gears in the matching row.

**Step 3:** If there are no matching gears, skip your turn. Fill in the totals and prompts with your dry erase marker. The player with the most gears in the end wins!

## FEATURES:



### REUSABLE AND DURABLE

Reusable dry erase materials offer repeated practice.



### SKILL DIFFERENTIATION

Double-sided for practice on two skill levels!



### TAKE IT FURTHER

Take it further with additional free resources, reproducibles, and downloadable content.



### DISPLAY AND STORAGE

Store materials vertically for a space saver. Book-shaped box fits shelves taller than 12".