

ADJUSTING TIME ZONE



Guide for troubleshooting Galaxy Tab Active 2, 3, 5's

1 Tap the "i" icon at the bottom left.



2 Tap Settings.

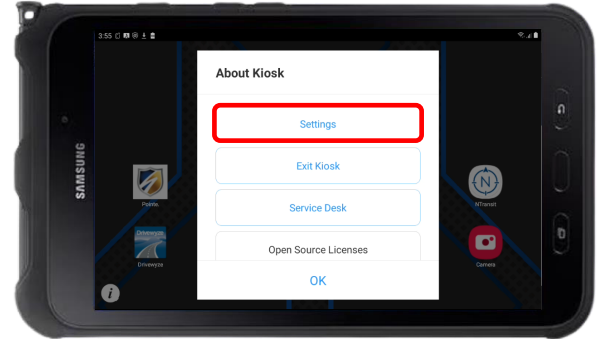

3 Scroll to the bottom (Swipe Up).

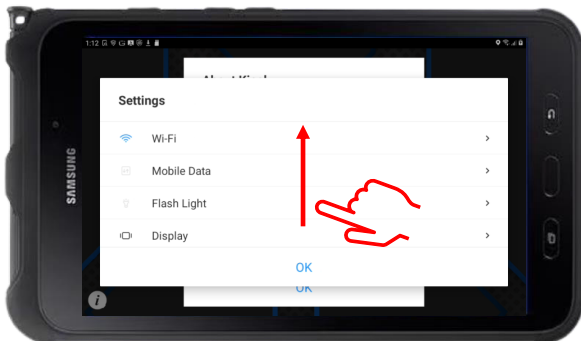

4 Tap Date and time.

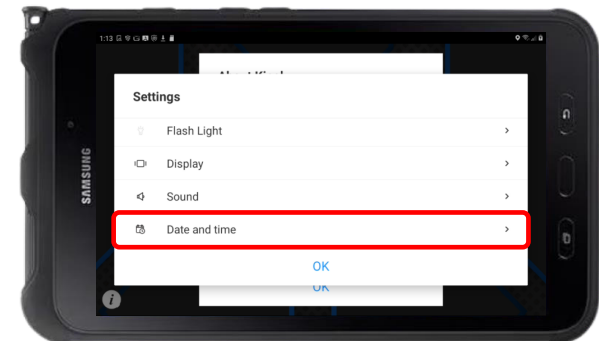

5 Automatic date and time is enabled by default. To further adjust, toggle switch.

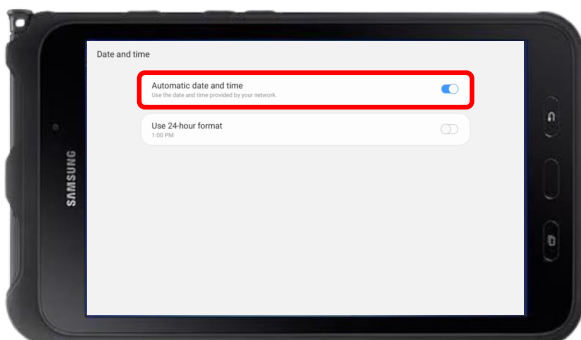

6 Success! Time zone can now manually be adjusted.

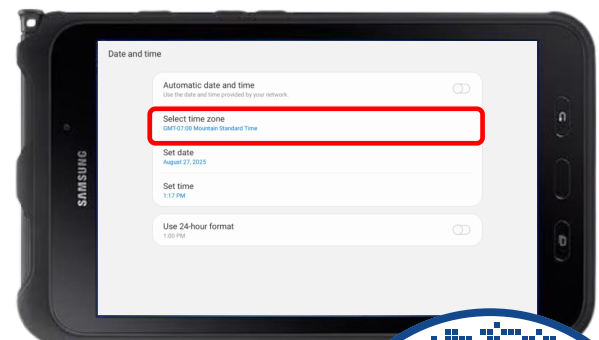

Document contains sensitive information - For internal use only

SCAN FLOWCODE
FOR MORE INFORMATION ON YOUR IN-CAB TECH

